

# Map Of CRAPO PARK

Burlington Iowa  
Established 1895

**CRAPO PARK**, Covering approximately 95 acres, is located two miles South on Main Street from the business center. Situated on the West side of the Mississippi River, the park possesses the natural beauty of sheer stone bluffs, deep ravines and majestic river views. All plant material in Crapo Park is individually tagged and numbered. The map shows the location of each tree. A supplemental booklet identifies the common and scientific name of each numbered plant.

**THE PURPOSE OF THIS MAP** is to increase the use and enjoyment of this beautiful and unusual park by the general public. Also to foster and preserve that the public spirit shown by the many individuals and organizations who by their contribution of specimens have assisted in making Crapo Park one of America's finest.

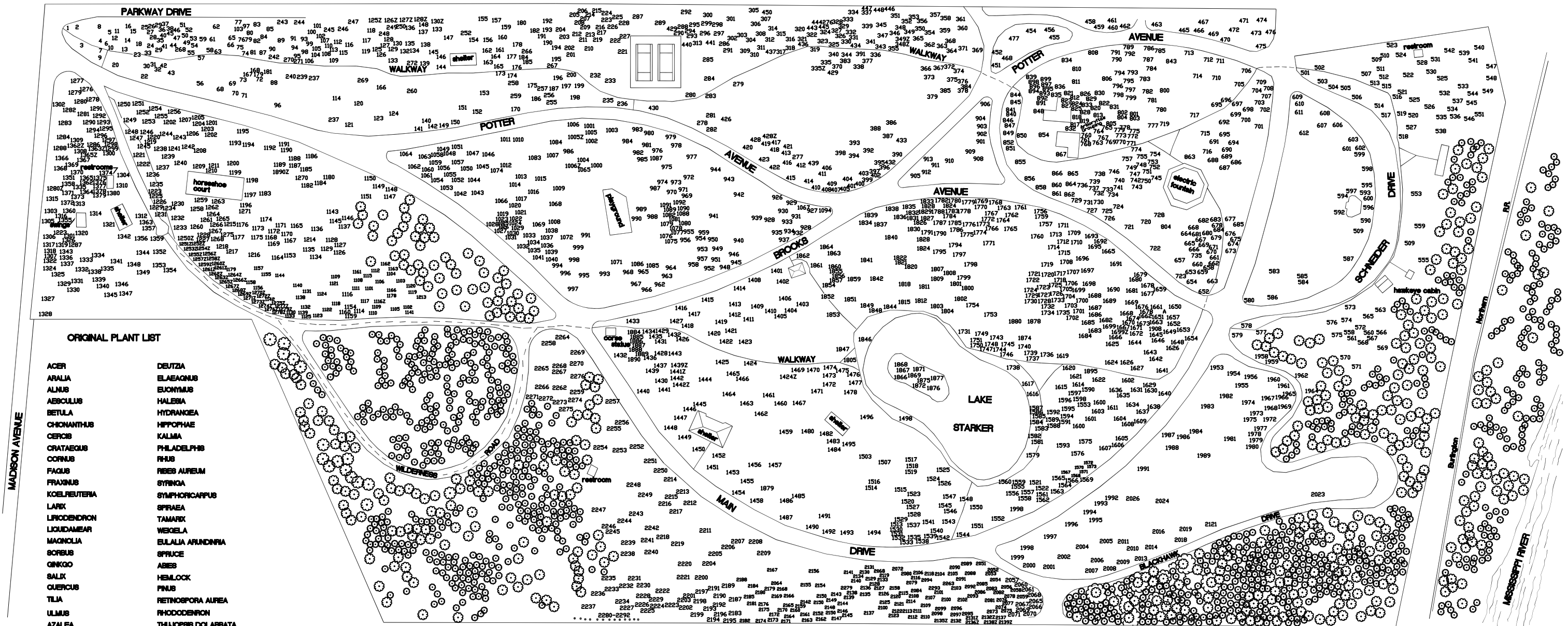

## ORIGINAL PLANT LIST

- |              |                      |
|--------------|----------------------|
| ACER         | DEUTZIA              |
| ARALIA       | ELAEAGNUS            |
| ALNUS        | EUONYMUS             |
| AESCULUS     | HALESIA              |
| BETULA       | HYDRANGEA            |
| CHONANTHUS   | HIPPOPHAE            |
| CERCIS       | KALIMA               |
| CRATAEGUS    | PHILADELPHIS         |
| CORNUS       | RHUS                 |
| FAGUS        | FRAX AUREUM          |
| FRAXINUS     | SYRINGA              |
| KOELFUERIA   | SYMPHORICARPUS       |
| LARIX        | SPYRAEA              |
| LIRIODENDRON | TAMARIX              |
| LIQUIDAMBAR  | WEGELIA              |
| MAGNOLIA     | EULALIA ARUNDINARIA  |
| SORBUS       | SPRUCE               |
| GINKGO       | ABIES                |
| SALIX        | HEMLOCK              |
| QUERCUS      | PINUS                |
| TILIA        | RETINOSPORA AUREA    |
| ULMUS        | RHODODENDRON         |
| AZALEA       | THAUJOPSIS DOLABRATA |
| BERBERIS     | MAHONIA              |
| CLETHRA      | YUCCA                |

## PRESENT PLANT LIST

every tree, shrub, and vine growing in crapo park has been plotted in its proper location on the above map

- |                       |                        |
|-----------------------|------------------------|
| EUROPEAN ALDER        | AMUR MAPLE             |
| APRICOT               | BOXELDER               |
| PERNNON               | JAPANESE MAPLE         |
| BRADFORD CALLERY PEAR | NORWAY MAPLE           |
| OSAGE ORANGE          | RED MAPLE              |
| EUROPEAN EUONYMUS     | SUGAR MAPLE            |
| AZALEA                | SILVER MAPLE           |
| HAWTHORN              | AESCULUS HIPPOCASTANUM |
| JAPANESE YEW          | ASIMINA TRILOBA        |
| AMERICAN CRANBERRY    | RIVER BIRCH            |
| CAMPDENOWN ELM        | BITTERNUT HICKORY      |
| RHODODENDRON          | PECAN                  |
| CAROLINA ALLSPICE     | SHELLBARK HICKORY      |
| WINGED EUONYMUS       | SHAGBARK HICKORY       |
| LILAC                 | CATALPA                |
| WIER'S CUTLEAF MAPLE  | HACKBERRY              |

- |                     |
|---------------------|
| EASTERN REDBUD      |
| FLOWERING DOGWOOD   |
| RED OSIER DOGWOOD   |
| RUSSIAN OLIVE       |
| WINGED EUONYMUS     |
| GREEN ASH           |
| HONEYLOCUST         |
| KENTUCKY COFFEETREE |
| BLACK WALNUT        |
| GOLDEN RAMTREE      |
| EASTERN LARCH       |
| TULIPTREE           |

- |               |
|---------------|
| HONEYSUCKLE   |
| STAR MAGNOLIA |
| CRABAPPLE     |
| RED MULBERRY  |
| JACK PINE     |
| MUGHO PINE    |
| AUSTRIAN PINE |
| BLUE SPRUCE   |
| RED PINE      |
| WHITE PINE    |
| SCOTCH PINE   |
| NORWAY SPRUCE |

- |                      |
|----------------------|
| SYCAMORE             |
| BLACK CHERRY         |
| DOUGLAS FIR          |
| BUR OAK              |
| BLACKJACK OAK        |
| PIN OAK              |
| RED OAK              |
| BLACK OAK            |
| BLACK LOCUST         |
| SPYRAEA              |
| BALD CYPRESS         |
| PYRAMIDAL ARBORVITAE |
| AMERICAN LINDEN      |
| SIBERIAN ELM         |
| EUROPEAN SNOWBALL    |
| WEGELA               |

- |                         |
|-------------------------|
| SWEET BIRCH             |
| EUROPEAN CUTLEAF LINDEN |
| TRI-COLOR BEECH         |
| SWAMP WHITE OAK         |
| EASTERN COTTONWOOD      |
| AMERICAN SWEETGUM       |
| FASTIGIATE ENGLISH OAK  |
| EUROPEAN BEECH          |
| TREE OF HEAVEN          |
| GINKGO                  |
| EASTERN RED CEDAR       |
| SCHWEDLER MAPLE         |
| BUTTERNUT               |
| TURKISH FILBERT         |
| EASTERN HEMLOCK         |

## ALPHABETICAL SECTION INDEX

